



FOAM CORE - WOOD VENEER DOOR CONSTRUCTION SPECS

Denton Door 5-Ply Premium Flush Door Construction:
All Denton Door Company Premium Architectural
Doors Type PC-5/FD-3 meet or exceed standards set
forth by WDMA I.S.1-A and the AWI for PC-5 as tested
per A.S.T.M. E-152 by Warnock Hersey International.

Top and Bottom Rails:
1-3/8" Thick SCL
(Stranded Composite Lumber)

Core Type:
Polystyrene cores insulate temperature and
sound while maintaining light weight and stiffness.

Crossband:
1/10" High Density Fiber Crossband

Stiles:
Hard wood over Stranded Composite Lumber (SCL)
Backer for stained edges
1-3/8" thick = 7/8" Solid Maple + 1/2" SCL before pre-fit

Faces:
White Maple, Red Oak, Birch, and more.
Premium, Grade A wood for wood face.

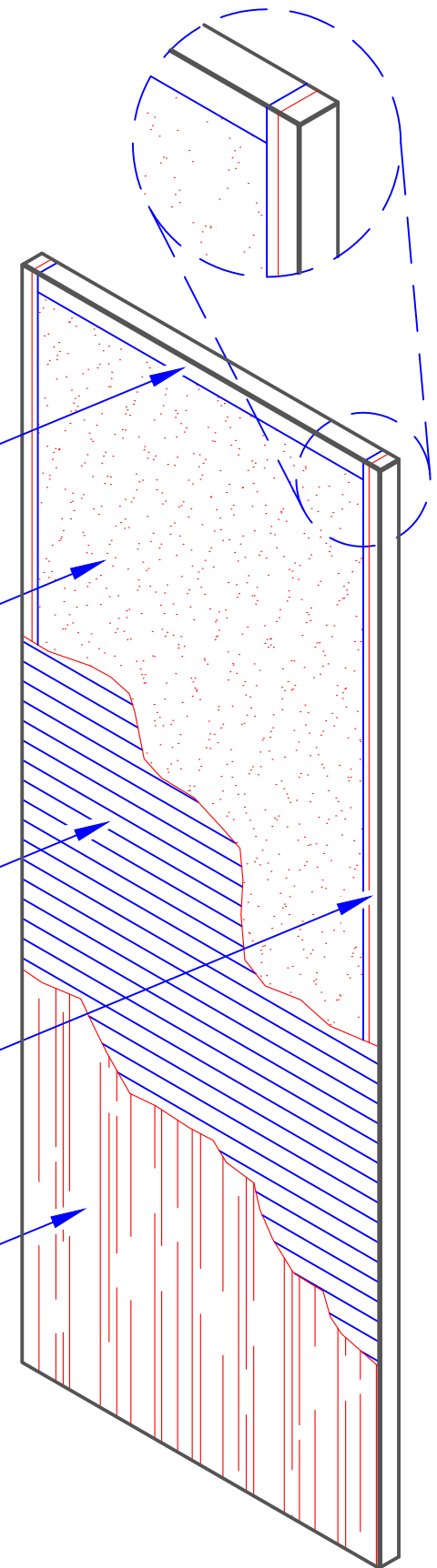

Adhesives: Meet requirements of WDMA I.S.1A, C-6

Door Thickness: 1-3/4"

Maximum Size: 4' x 9'

Warranty: Premium Architectural Doors (Lifetime Warranty)

Note: Interior use only. (Exterior use applications not warranted.)